

If not otherwise mentioned:  
 Cross sections looking forward.  
 Longitudinal sections looking from  
 starboard to portside.

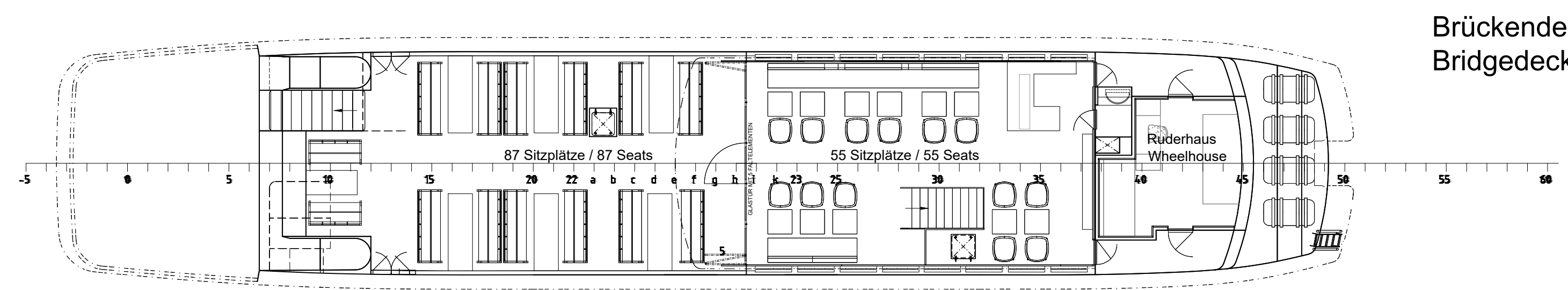

Brückendeck  
Bridgdeck

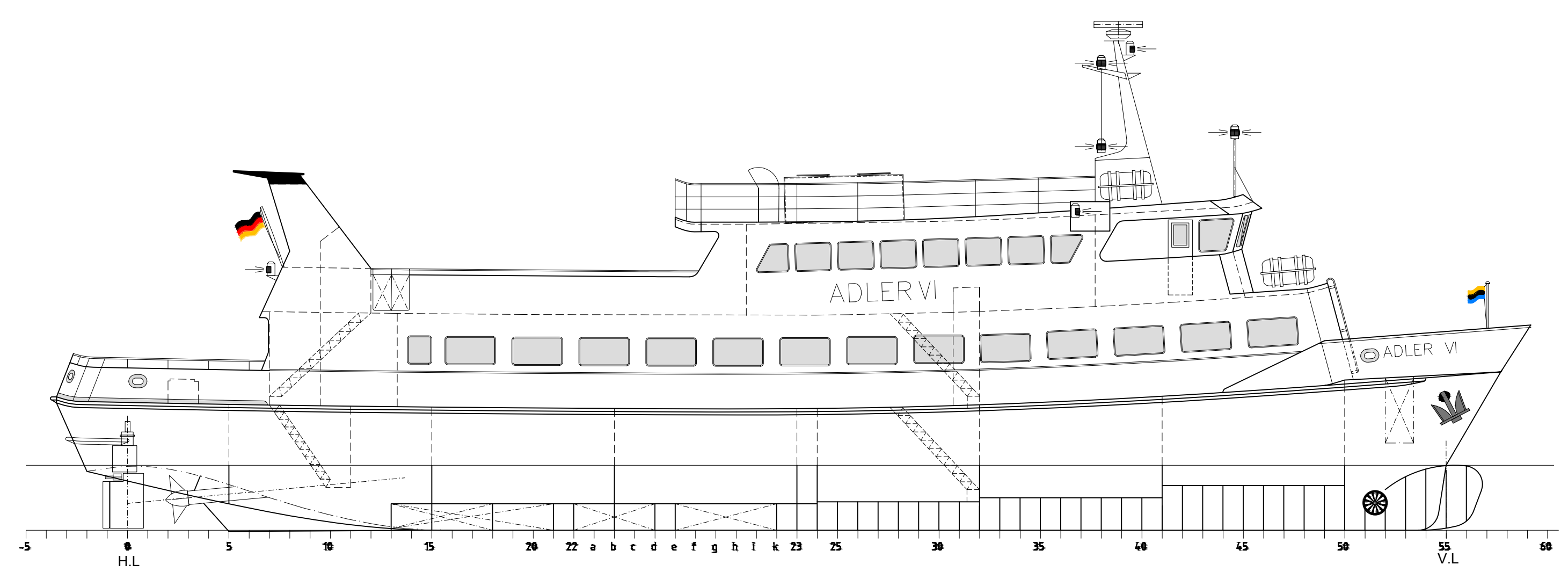
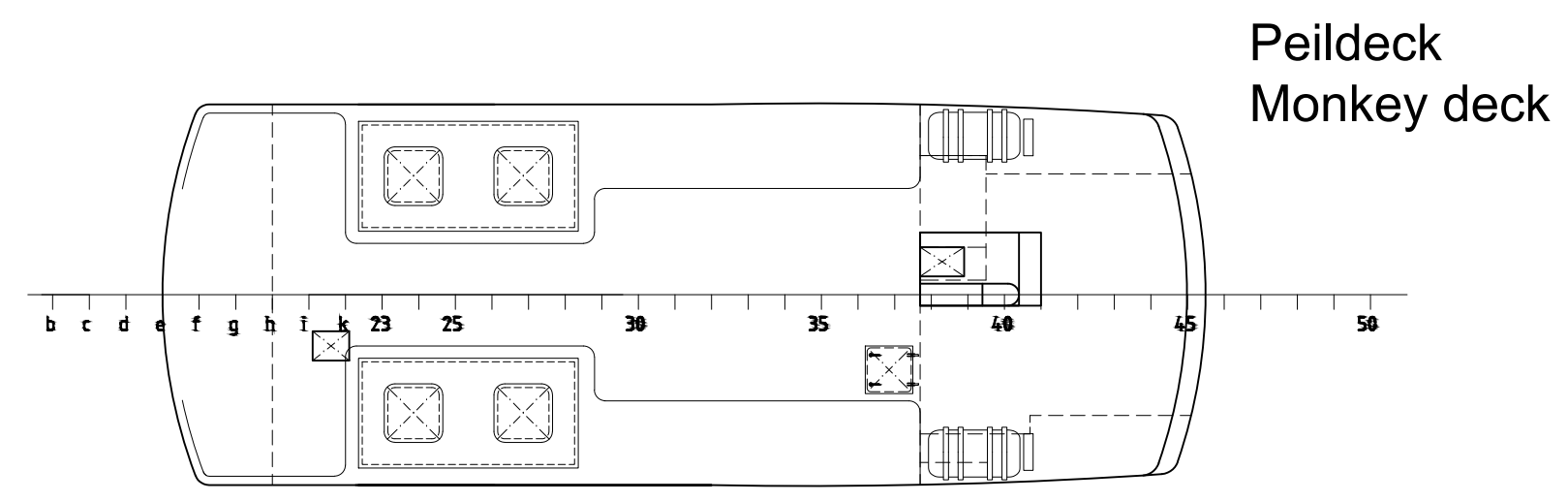

Peildeck  
Monkey deck

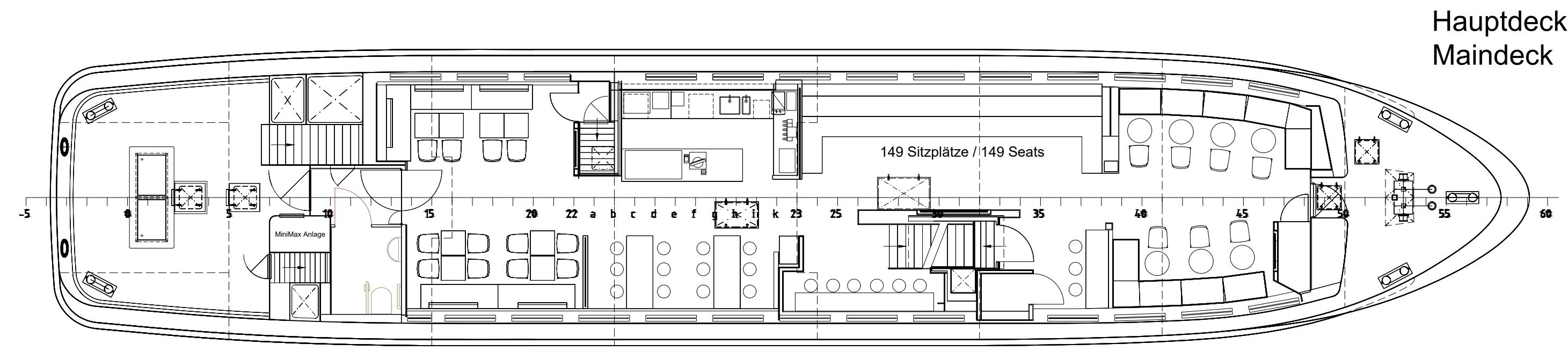

Hauptdeck  
Maindeck

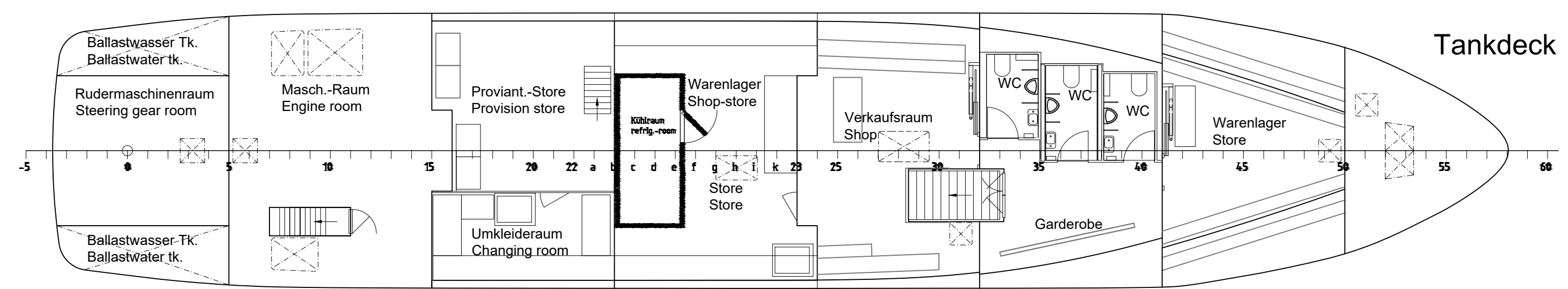

Tankdeck

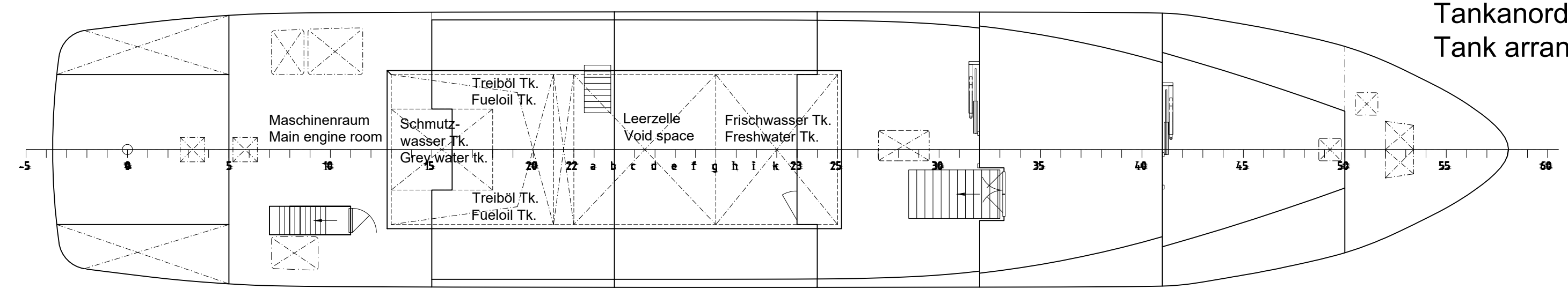

Tankanordnung  
Tank arrangement

| Hauptabmessungen / Main dimensions                   |                             |                 |       |
|--|-----------------------------|-----------------|-------|
| Länge ü.a / Length o.a.                              | 36.77 m                     |                 |       |
| Länge zw. d. Loten / Length b.p.                     | 32.50 m                     |                 |       |
| Breite a. Spant / Beam moulded                       | 6.90 m                      |                 |       |
| seitenhöhe Hauptdeck / Depth to maindeck             | 3.00 m                      |                 |       |
| Tiefgang auf Freibord / Freeboard draught            | 1.70 m                      |                 |       |
| Vermessung / Tonnage                                 | 220 BRZ                     |                 |       |
| Hauptmaschine / Main engine                          | -                           |                 |       |
| Klassezeichen / Classification                       | Fahrtgebiet / Area          |                 |       |
| GL 100 A 5, K,<br>Fahrgastschiff mit Freibord 1.30 m | Nationale Fahrt / Wattfahrt |                 |       |
| Bauwert / Shipyard                                   | Husumer Schiffswert         | Baujahr         | 1980  |
| Neubau Nr. / Newbuilding No.                         | 1456                        | GL Register Nr. | 16254 |

| Rev | MODIFICATION / DESIGNATION | Date | Name |
|-----|----------------------------|------|------|
| C   | -                          | -    | -    |
| B   | -                          | -    | -    |
| A   | -                          | -    | -    |

| SEH  |      | M/V "ADLER VI" |        | TITLE                 |        |
|--|------|----------------|--------|-----------------------|--------|
| The design presented in this drawing is property of SEH, Hamburg, Germany. It must not be handed over to third parties without the written permission of SEH. It must not be used for other purposes than specified in the contract even in modified form without the written permission of SEH. | 2023 | Date           | 27.08. | Name                  | CB-SEH |
| Drawn  | -    | Checked        | -      | Approved              | -      |
| Allgemeiner Anordnungsplan<br>General arrangement Plan   |      |                |        | Scale<br>1:100        |        |
| DRAWING-NO.:<br>H0109-1001   |      |                |        | Sheet<br>1<br>of<br>1 |        |